



# Starlink Mini Suction Mount

Suits Starlink Mini

(MOD-M-UNI-STARSUCT-P)

A BOSS ALUMINIUM DESIGN

BOSS BUILT, ADVENTURE READY

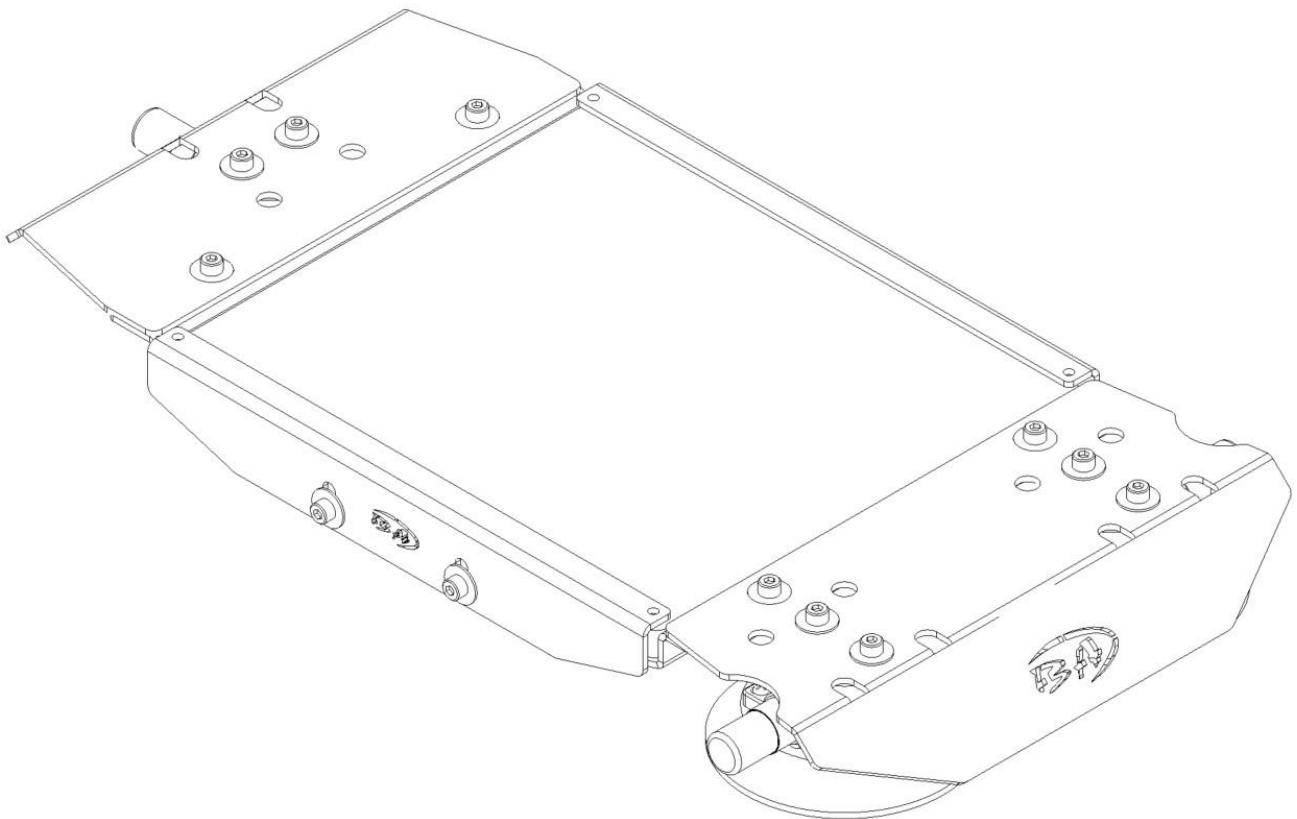



Dear Valued Customer,

Thank you for choosing the Starlink Mini Suction Mount, specially designed for seamless integration with your Starlink system. We're thrilled to have you as part of our community and are confident that your new mount will enhance your connectivity and adventure experience.



What's in the box		QTY
1	Side Bracket	2
2	Rear Mount Plate	1
3	Front Mount Plate	1
4	Starlink Mini Cradle	1
5	Bolt M6 x 20	8
6	Bolt M6 x 30	6
7	Spring Washer M6	8
8	Flat Washer M6 x 20	14
9	Flat Washer M6 x 12	6
10	Nylon Lock Nut M6	6
11	Spacer Plate	3
12	SeaSucker Mount	3

*Please note that the Starlink Mini is not included in this kit.*

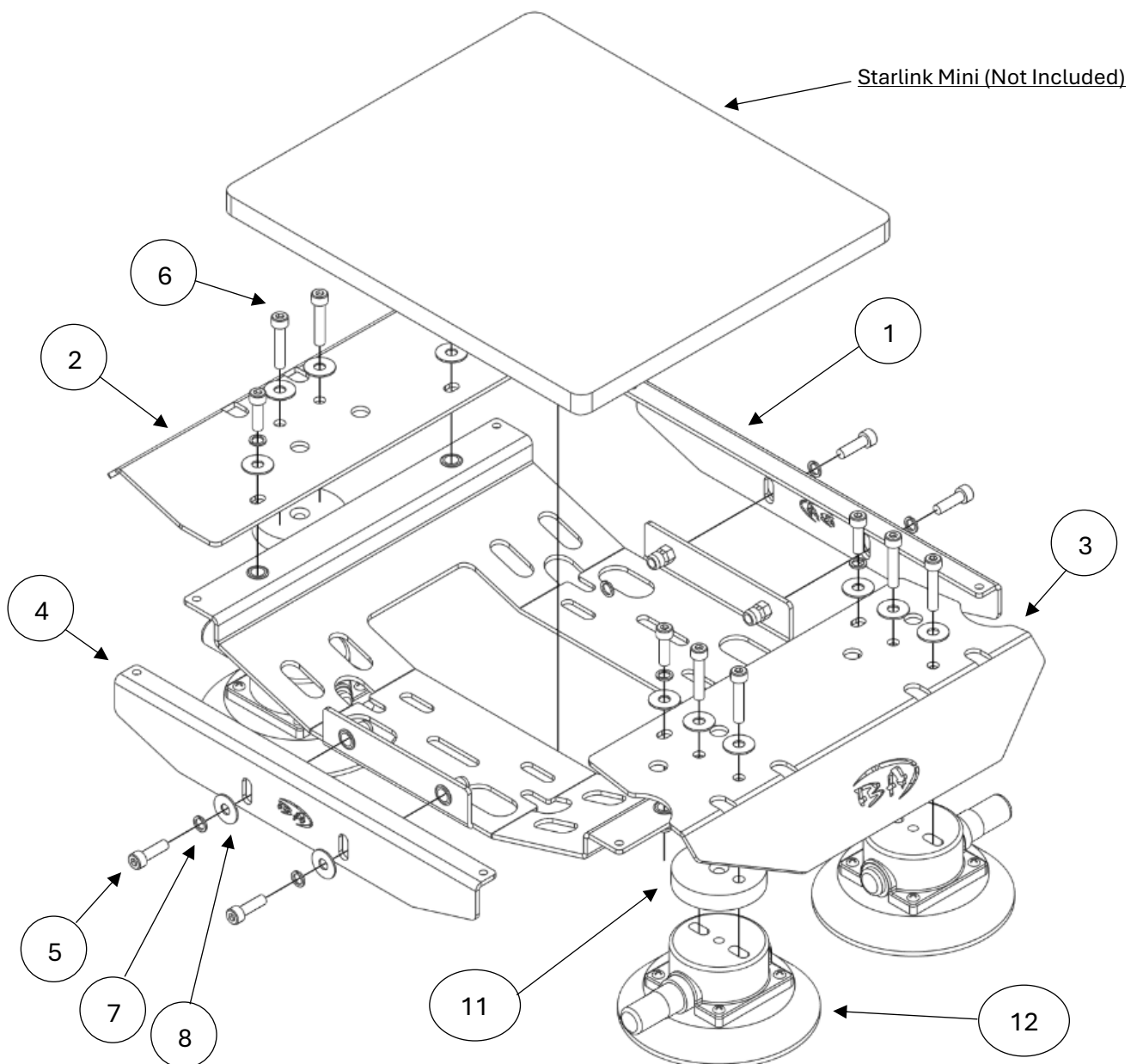

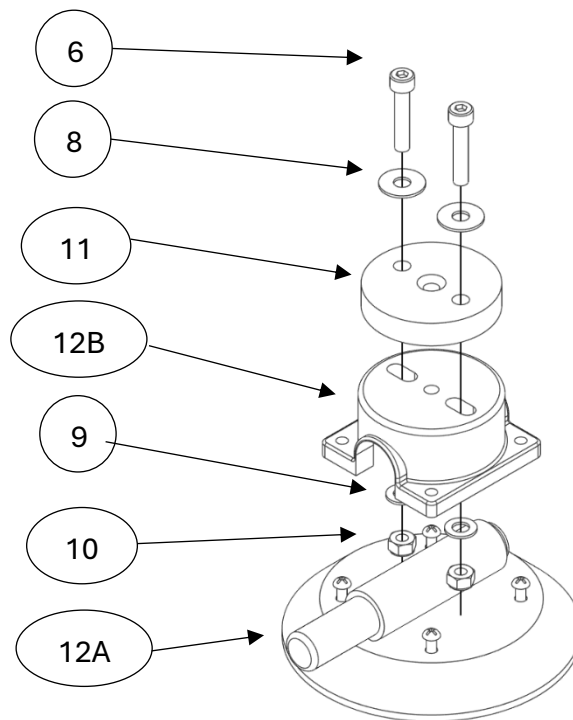

<b>Optional Extras – See website for more details</b>
---

Starlink Mini Mount Package
-----------------------------

Additional Base Plate
-----------------------

Side Brackets
---------------

Boss Base Rack Brackets (Pair) – Suits ARB Base Rack
--

Boss Protective Cover to suit the Starlink Mini
---

Mounting Hardware Kits
------------------------

SeaSucker 4.5" Vacuum Mount
-----------------------------

<b>Required Tools (Not Supplied)</b>
--------------------------------------

Phillips Head Screwdriver
---------------------------

5mm Allen Key
---------------

10mm Socket
-------------

243 Medium Loctite
--------------------



---

## Assembly

---

Please note that it is crucial to follow the Usage Guide provided with the SeaSucker mounts. Failure to do so may result in damage, for which Boss Aluminium will not be held liable.

Additionally, we strongly recommend using a lashing strap or similar device to anchor the mount to your vehicle, especially in the event the suction seal is broken. This extra precaution can help prevent accidents or damage.

---

### Quick Tips for Using SeaSucker Vacuum Mounts

- **Clean the Surface** – Use **mild soap and water**, not window cleaner or solvents.
- **Lightly Wet the Cup** – A few drops of water on the **rubber edge** help create the best seal.
- **Pump Until the Orange Band Disappears** – If it reappears, pump again to restore suction.
- **Check Before Use** – Always inspect and re-pump if needed before hitting the road.
- **Avoid Rough or Porous Surfaces** – Stick to **glass, metal, painted, fiberglass, or glossy plastic**.
- **Store with the Protective Cover** – Keeps the rubber clean and prevents deformation.
- **Lubricate the Pump Only** – Use **food-grade silicone lubricant** on the pump shaft, never on the suction cup.
- **Re-pump Every Few Hours on Long Trips** – Especially in extreme temperatures.

---

**Notice :** When fitting bolts, it's important to apply a sufficient amount of genuine 243 Medium Loctite to each bolt to ensure a secure hold.

---

#### **Assembly Video**

For in-depth video walkthrough of assembly process please scan QR code and follow YouTube link.



---

#### **SeaSucker Vacuum Mount User Guide**

Website link to the digital version of the SeaSucker vacuum mount user guide provided with the mounts.





1. Disassemble SeaSucker Mount (12), removing all 4 screws. This creates SeaSucker Bottom (12A) and SeaSucker Top (12B). Do not misplace the screws from this step as they will be used later. Repeat this step for all 3 suction mounts.

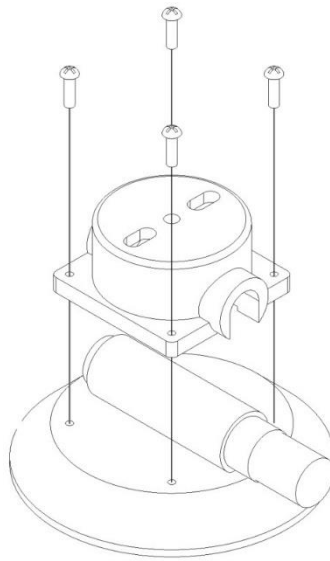

2. Using the Bolt M6 x 30 (6) x QTY 2, Flat Washer M6 x 20 (8) x QTY 2, Flat Washer M6 x 12 (9) x QTY 2, Nylon Lock Nut M6 (10) x QTY 2 and Spacer Plate (11) x QTY 1, bolt the SeaSucker Top (12B) x QTY 1 and Spacer Plate (11) x QTY 1, to Rear Mount Plate (2) x QTY 1. Next bolt the SeaSucker Top (10B) x QTY 2 and Spacer Plate (11) x QTY 2, to Front Mount Plate (3) x QTY 1.

Please note the extrusions on the Spacer Plate (11) should lock into the slots on the top of the SeaSucker Top (12B). Make sure the SeaSucker Top (12B) components are orientated with the allowance for the plunger in the housing facing the cut outs in the Front Mount Plate (3) and Rear Mount Plate (2) as per image below.

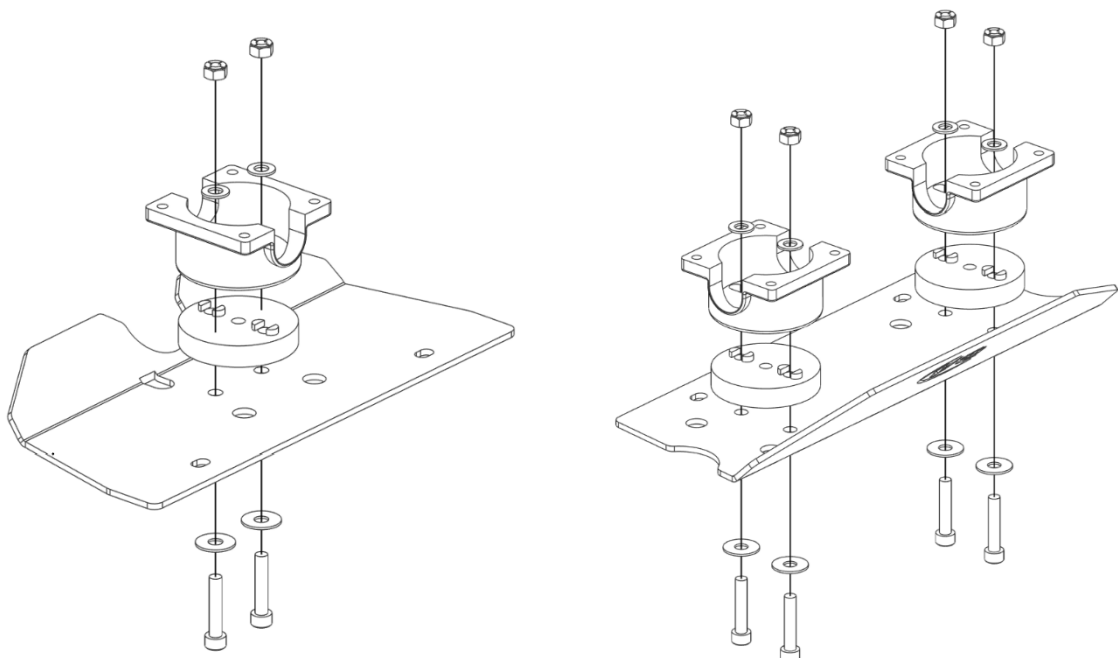



3. Using the original bolts x QTY 12 from the SeaSucker Mounts (12) x QTY 3, bolt SeaSucker Bottom (12A) x QTY 3 to the SeaSucker Top (12B) x QTY 3 assemblies created in step 2.

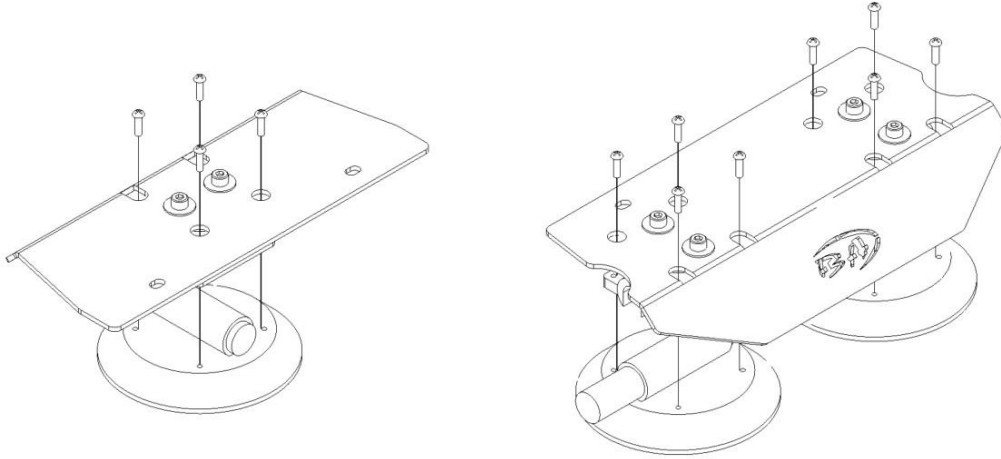

4. Using the Bolt M6 x 20 (5) x QTY 4, Spring Washer M6 (7) x QTY 4, Flat Washer M6 x 20 (8) x QTY 4, bolt the assemblies from step 3 to Starlink Mini Cradle (4) x QTY 1.

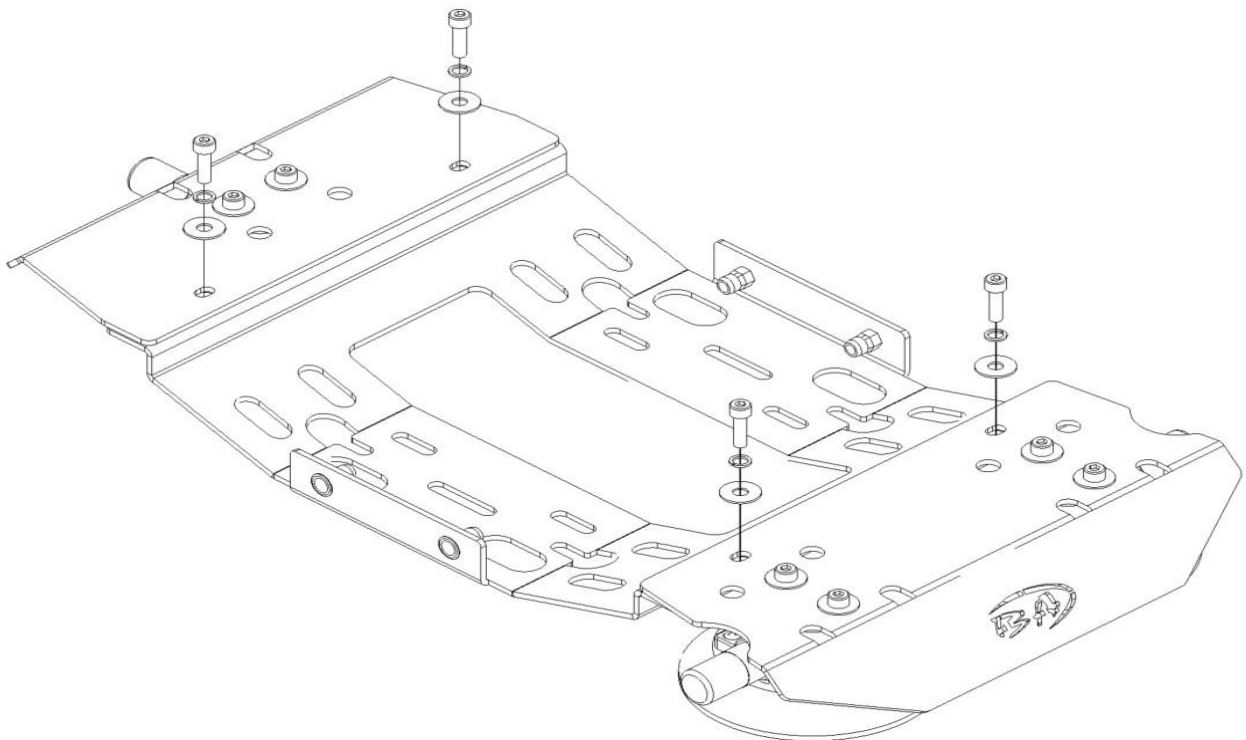



5. Place Starlink Mini (not included) into the assembled Starlink Mini Cradle (4).

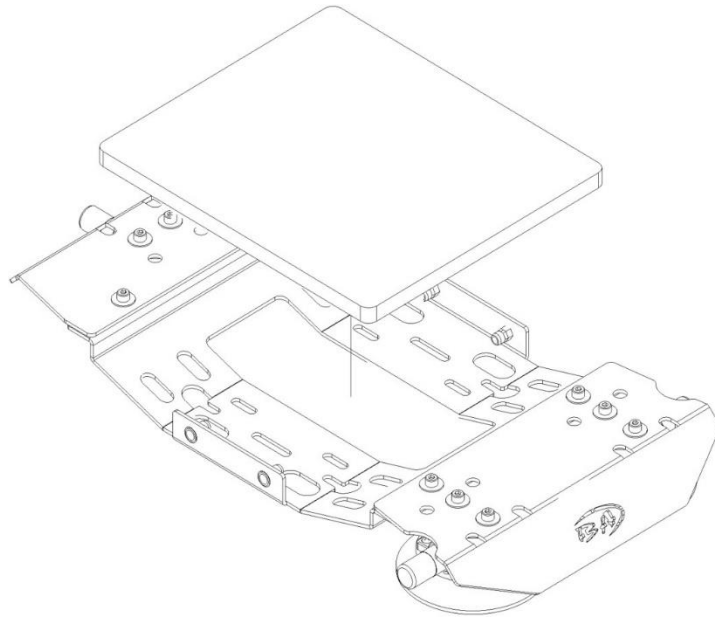

6. Using Bolt M6 x 20 (5) x QTY 4, Spring Washer M6 (7) x QTY 4, Flat Washer M6 x 20 (8) x QTY 4, bolt Side Brackets (1) x QTY 2 to assembled Starlink Mini Cradle (4), making sure the Starlink Mini is held securely in place.

If purchased separately insert the Boss Protective Cover to suit the Starlink Mini between the Starlink Mini and Side Brackets (1). As per image below.

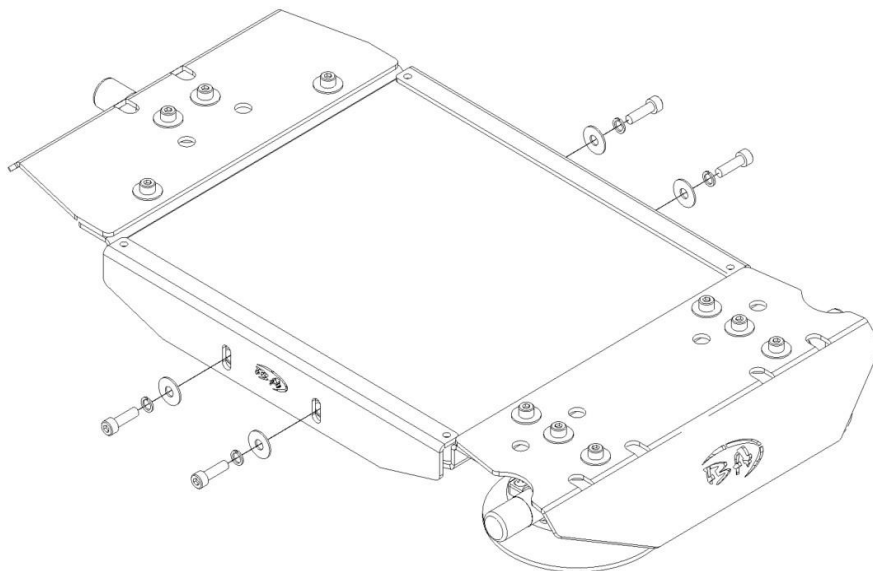

7. Fit assembled mount to desired non-porous surface ensuring to follow Sea Sucker Usage Guide.





---

## How to Properly Mount a SeaSucker Vacuum Mount

To ensure maximum suction and a secure hold, follow these step-by-step instructions for mounting your **SeaSucker** vacuum mount.

Following these steps will ensure **a strong, long-lasting suction** for your **SeaSucker** mount.

---

### 1. Choose the Right Surface

#### **Best Surfaces:**

- **Glass** (e.g., windshields, windows)
  - **Metal** (e.g., car roofs, doors)
- **Painted surfaces** (must be smooth and clean)
  - **Fiberglass** (smooth, non-textured)
- **Glossy plastic** (e.g., hard, non-porous plastics)

#### **Avoid Surfaces That Are:**

- **Textured or rough** (reduces suction strength)
- **Porous** (e.g., fabric, matte plastic, wood)
- **Dirty, oily, or waxed** (interferes with adhesion)

---

### 2. Clean the Surface Properly

 **Use Mild Soap & Water** - Wash the surface with warm water and mild dish soap to remove dirt, oils, and wax.

 **Dry Thoroughly** - Wipe with a lint-free cloth before mounting.

 **Do NOT use solvents, window cleaners, alcohol, or petroleum-based products** - these may leave a residue that weakens suction.

---

### 3. Prepare the Suction Cup

#### **Inspect the Vacuum Cup**

- Ensure it's **clean and free of dust or debris**.
- If dirty, wash with **mild soap and warm water**, then let it air dry.

#### **Lightly Wet the Suction Cup (Critical Step!)**

- Apply **a few drops of water** to the **outer edge** of the suction cup.
- Spread the water **evenly with your finger** - this helps eliminate micro air gaps.

 **Do NOT use lubricants, oils, or solvents on the suction cup.**



---

#### **4. Attach the SeaSucker**

##### **✓ Place the Suction Cup on the Surface**

- Align the mount and **press it firmly** against the surface to spread the water evenly.

##### **✓ Pump the Plunger to Create Vacuum**

1. **Start pumping** the plunger **until the orange indicator disappears**.
  2. If the orange band reappears over time, **re-pump it to restore suction**.
  3. **Give the mount a firm tug** to ensure its properly attached.
- 

#### **5. Periodic Checks, Pre-Use Inspection & Removing the Mount**

##### **✓ Check Before Use**

- Before every use, **inspect the orange vacuum indicator**—if it's visible, **re-pump** to restore full suction.
  - Ensure the mount is **securely attached** by giving it a firm pull.

##### **✓ Check During Use**

- On long trips, check the mount **every 2-3 hours** and pump if needed.

##### **✓ How to Remove the SeaSucker**

1. **Lift the edge tab** of the suction cup to break the seal.
2. **Do NOT pull on the mount itself**, as this can damage the cup.

##### **✓ Storage & Maintenance**

- **Use the protective cover** when not in use to keep the rubber clean.
    - **Wash the cup regularly with mild soap and water.**
    - **Store in a cool, dry place** to avoid deformation.
  - **Lubricate the pump mechanism only with food-grade silicone lubricant**—never apply it to the suction cup.
- 

#### **Troubleshooting Common Issues**

##### **🚨 Loss of Suction Too Quickly?**

- ✓ Ensure the **mounting surface is clean and dry**.
- ✓ Re-clean the vacuum cup with **mild soap and water**.
- ✓ If cold, **warm the rubber slightly** with your hands before applying.

##### **🚨 Mount Slides on Wet Surface?**

- ✓ Use **less water**—just enough to dampen the rubber edge.
  - ✓ Avoid mounting on **extremely wet or waxed surfaces**.
-



## Social Media

---

Stay connected with our latest designs and product releases and share your Starlink Mini Suction Mount in action! Follow us and tag us on social media to showcase your setup or adventure – we'd love to see how you're using it!

Instagram	bossaluminium
Facebook	Boss Aluminium Pty. Ltd.
YouTube	@bossaluminium
Tik Tok	@bossaluminium
LinkedIn	Boss Aluminium

We stand behind our products 100%. If you encounter any issues or need assistance, please contact our team. Your feedback helps us continue to innovate and provide the best solutions for our customers.

Thank you for choosing the Starlink Mini Suction Mount. Here's to better connectivity and new adventures ahead!

## Warranty Information

---

We back our manufacturing with a complete lifetime warranty on our workmanship, guaranteeing longevity and peace of mind when you load up your canopy and hit the road.

---

---

This company shall not be held responsible for any damages, injuries, or losses arising from the use, installation, or improper handling of this product. The customer assumes all risks associated with its installation and operation and is responsible for ensuring proper use according to the provided instructions and guidelines.

Please note that it is crucial to follow the Usage Guide supplied with the SeaSucker mounts, as failure to do so may result in damage, for which we will not be held liable. For added safety, we strongly recommend using a lashing strap or similar device to anchor the mount to your vehicle, particularly in the unlikely event the suction seal is broken. For optimal safety and proper installation, this product should be installed by a professional.

---



## NOTES:

---

This page has been intentionally left blank