

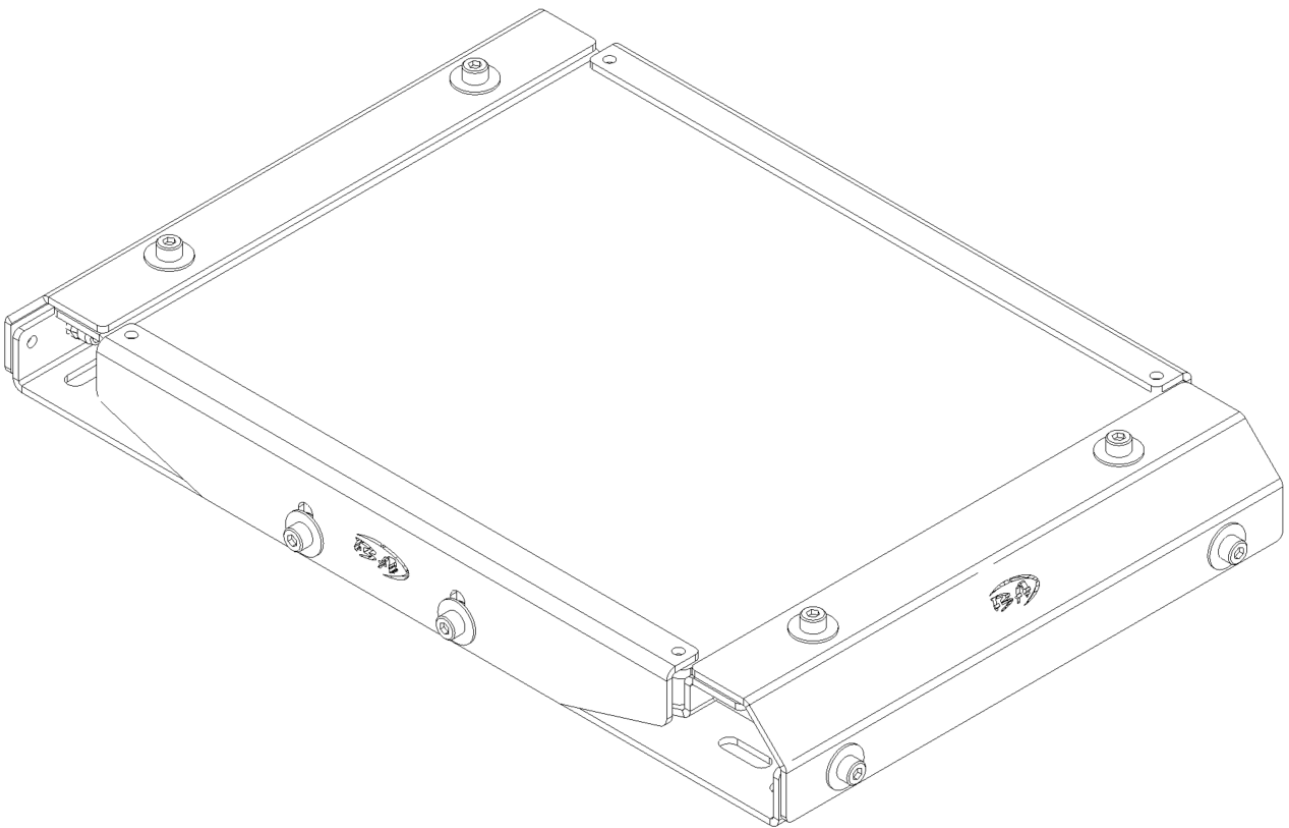

Starlink Mini Mount Package

Suits Starlink Mini
(MOD-M-UNI-STARMIN)

A BOSS ALUMINIUM DESIGN
BOSS BUILT, ADVENTURE READY





Dear Valued Customer,

Thank you for choosing the Boss Mini Mount, specially designed for seamless integration with your Starlink system. We're thrilled to have you as part of our community and are confident that your new mount will enhance your connectivity and adventure experience.



What's in the box		QTY
1	Side Brackets	2
2	End Brackets	2
3	Mounting Base	1
4	Starlink Mini Cradle	1
5	Bolt M6 x 20	12
6	Spring Washer M6	12
7	Flat Washer M6 x 20	12

Please note, Starlink Mini and Mounting Hardware are not included in kit.

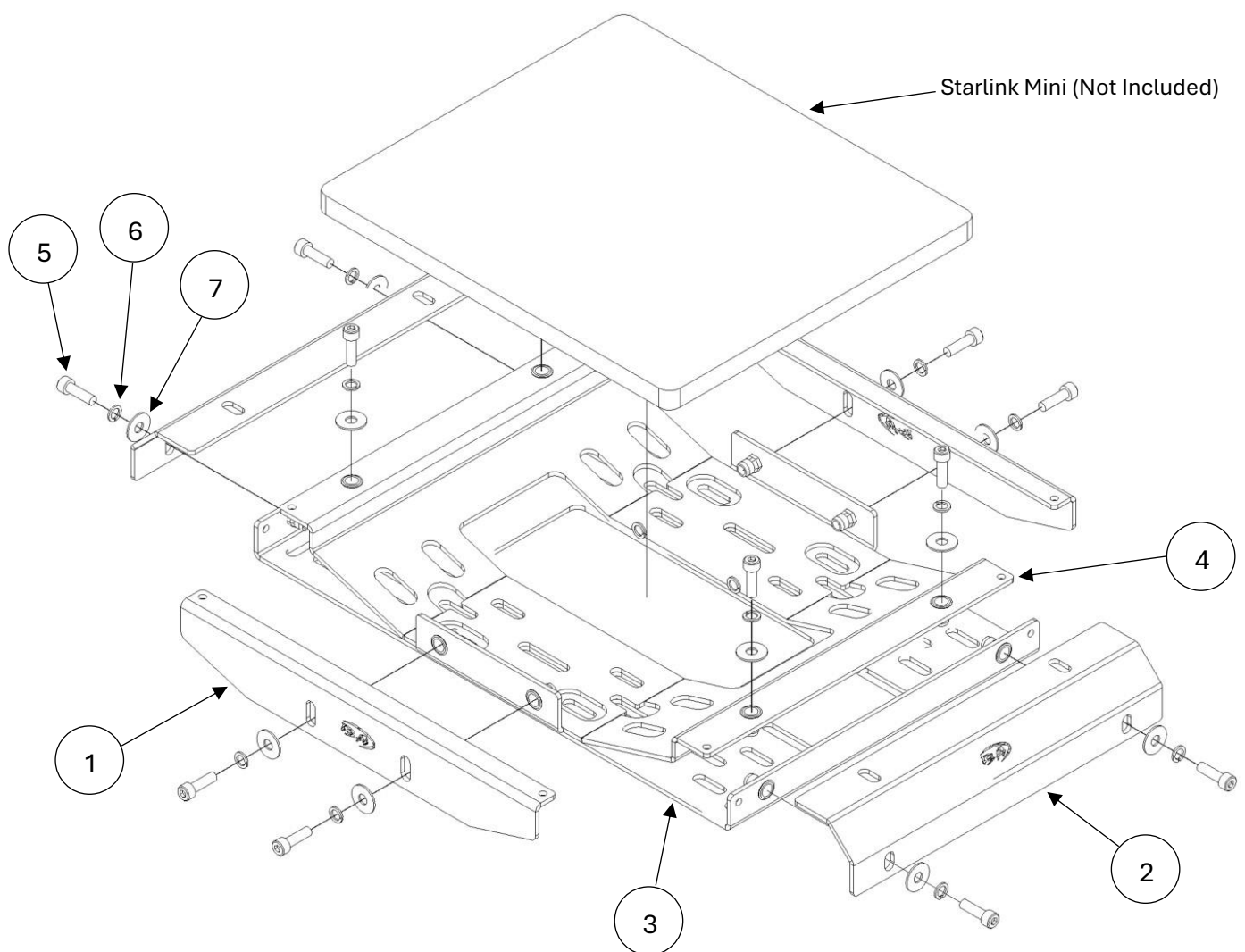

Optional Extras – See website for more details

Additional Base Plate

Starlink Mini Suction Mount Package

Boss Base Rack Brackets (Pair) – Suits ARB Base Rack

Boss Protective Cover to suit the Starlink Mini

Mounting Hardware Kits



Required Tools (Not Supplied)

5mm Allen Key

243 Medium Loctite

Assembly

Notice : When fitting bolts, it's important to apply a sufficient amount of genuine 243 Medium Loctite to each bolt to ensure a secure hold.

1. Using Bolt M6.0 x 20 (5) x QTY 4, Spring Washer M6 (6) x QTY 4, Flat Washer M6 x 20 (7) x QTY 4, loosely bolt Starlink Mini Cradle (4) x QTY 1 and End Brackets (2) x QTY 2 together.

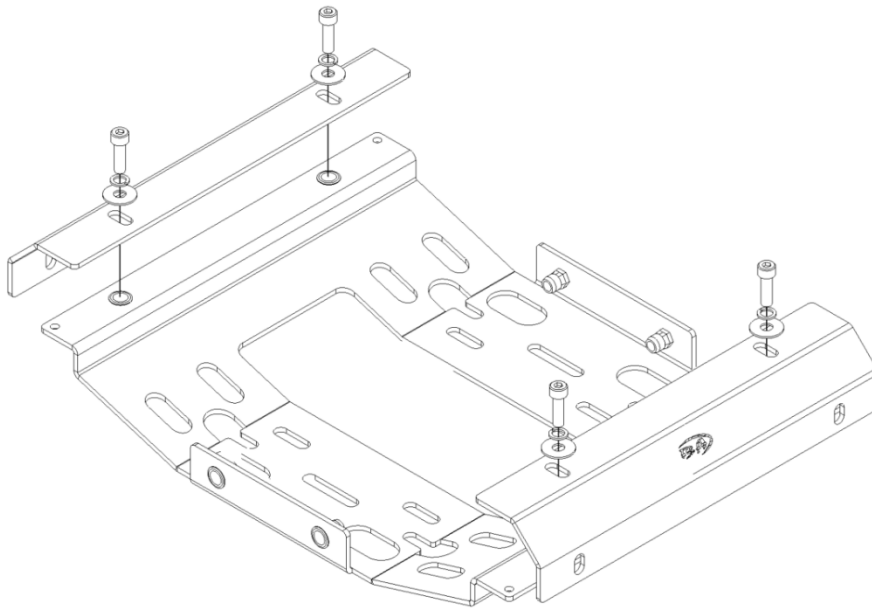

2. Using Bolt M6.0 x 20 (5) x QTY 4, Spring Washer M6 (6) x QTY 4 and Flat Washer M6 x 20 (7) x QTY 4, lower and loosely bolt the assembly from step 1 to the Mounting Base (3) x QTY 1. Once together tighten all 8 bolts.

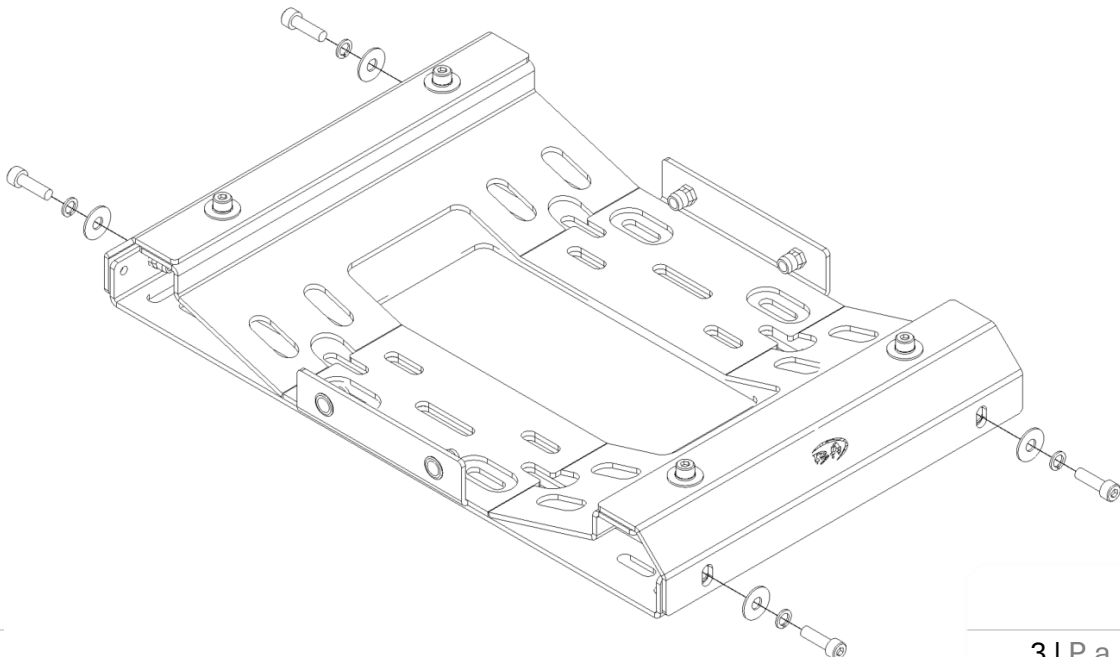



3. Fit Boss Mini Mount (mounting hardware kit not included) to desired location. For optimal mounting of your Starlink Mini, it is highly recommended to evenly distribute the mounting hardware across the base and ensure that both sides of the base plate are supported.

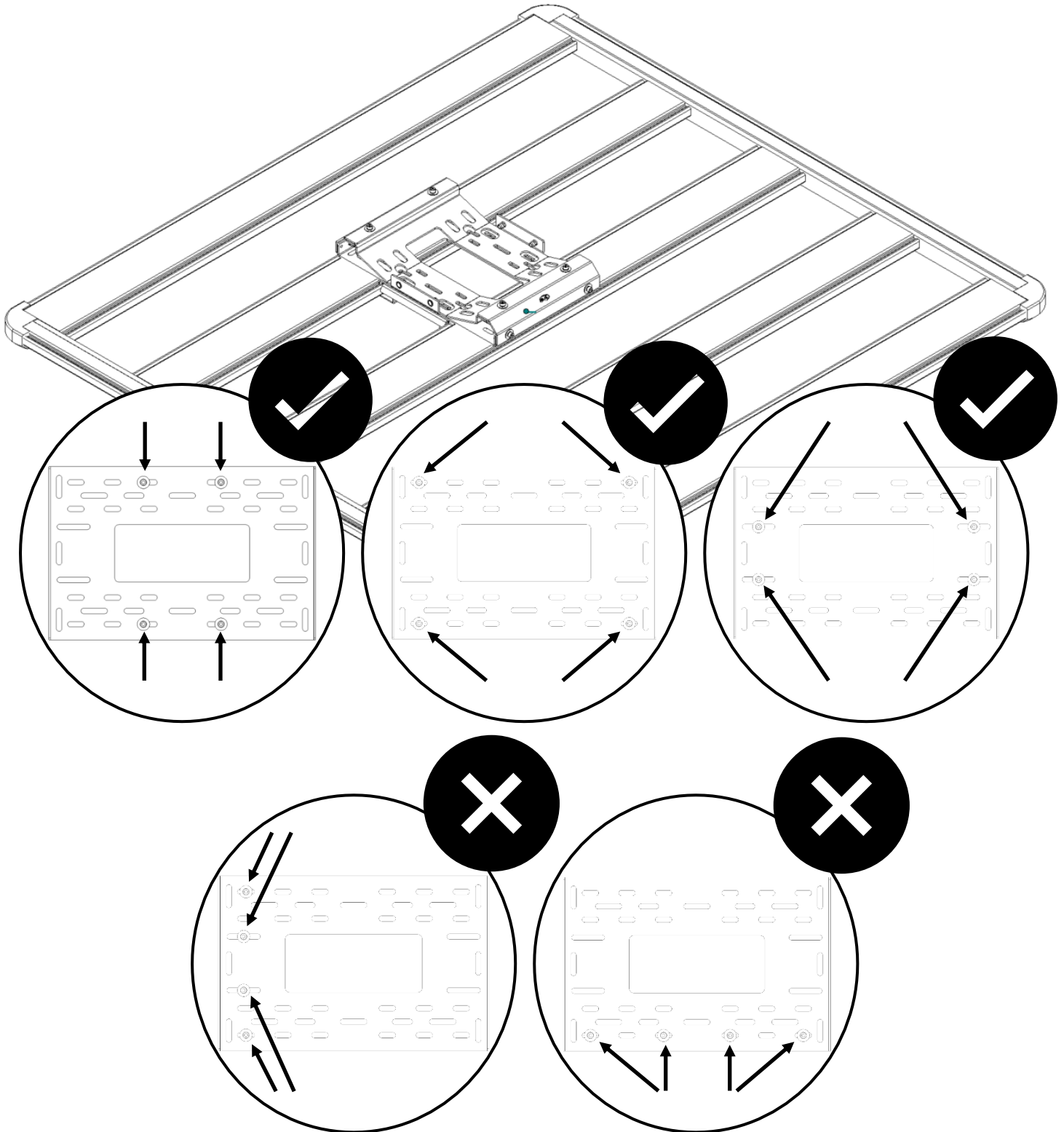



4. Place Starlink Mini (not included) into the Boss Mini Mount.

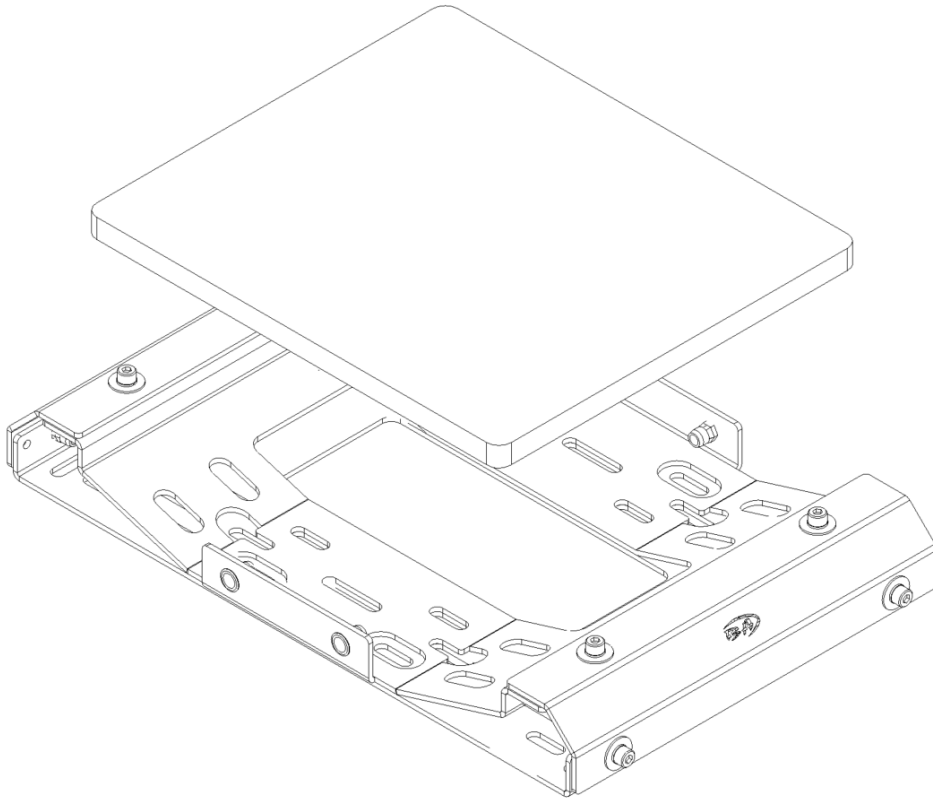

5. Using Bolt M6.0 x 20 (5) x QTY 4, Spring Washer M6 (6) x QTY 4, Flat Washer M6 x 20 (7) x QTY 4, bolt Side Brackets (1) x QTY 2 to Starlink Mini Cradle (4), making sure the Starlink Mini is held securely in place.

If purchased separately insert the Boss Protective Cover to suit the Starlink Mini between the Starlink Mini and Side Brackets (1).

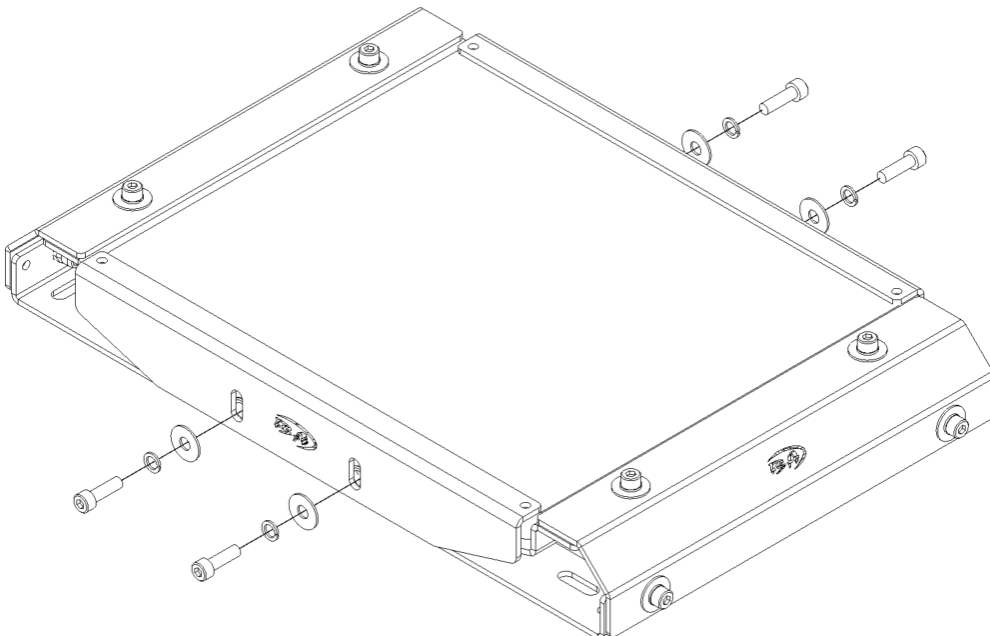



Social Media

Stay connected with our latest designs and product releases and share your Boss Mini Mount in action! Follow us and tag us on social media to showcase your setup or adventure – we'd love to see how you're using it!

Instagram	bossaluminium
Facebook	Boss Aluminium Pty. Ltd.
YouTube	@bossaluminium
Tik Tok	@bossaluminium
LinkedIn	Boss Aluminium

We stand behind our products 100%. If you encounter any issues or need assistance, please contact our team. Your feedback helps us continue to innovate and provide the best solutions for our customers.

Thank you for choosing the Boss Mini Mount. Here's to better connectivity and new adventures ahead!

Warranty Information

We back our manufacturing with a complete lifetime warranty on our workmanship, guaranteeing longevity and peace of mind when you load up your canopy and hit the road.

This company shall not be held responsible for any damages, injuries, or losses arising from the use, installation, or improper handling of this product. The customer assumes all risks associated with its installation and operation and is responsible for ensuring proper use according to the provided instructions and guidelines. For safety and proper installation, this product should be installed by a professional.